

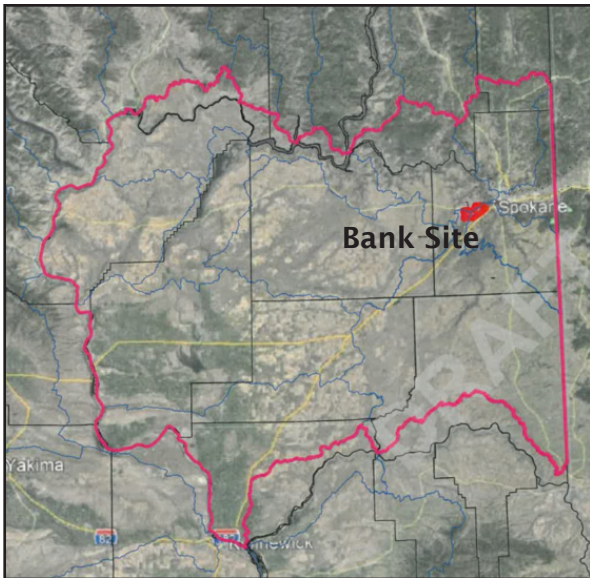



# Wetland Mitigation Bank\*

*\*In Development*



A wetland mitigation bank is a site where wetlands are restored, created, enhanced or in exceptional circumstances preserved for the express purpose of providing compensatory mitigation in advance of unavoidable impacts to wetlands or other aquatic resources. Banks provide the option of purchasing credits to offset the unavoidable impacts of a project.

## Proposed Service Area



-  The West Plains is one of the fastest growing areas in Washington State and contains over 300 acres of small, isolated wetlands.
-  To accommodate the growth and lessen impacts to the wetlands, S3R3 Solutions is in the process of creating a wetland mitigation bank.
-  The wetland mitigation bank will be used as compensatory mitigation to offset wetland impacts in the West Plains and a broader Service Area within our region.
-  The wetland mitigation bank provides certainty of project schedule, budget, and outcome.

## Wetland Mitigation Bank Site

-  Approximately 400 acres.
-  Located between Cheney and Tyler in the southwestern portion of Spokane County.
-  More than five miles away from both the Spokane International Airport and Fairchild Air Force Base; preventing typical wetland wildlife from posing hazards to aircraft operations.

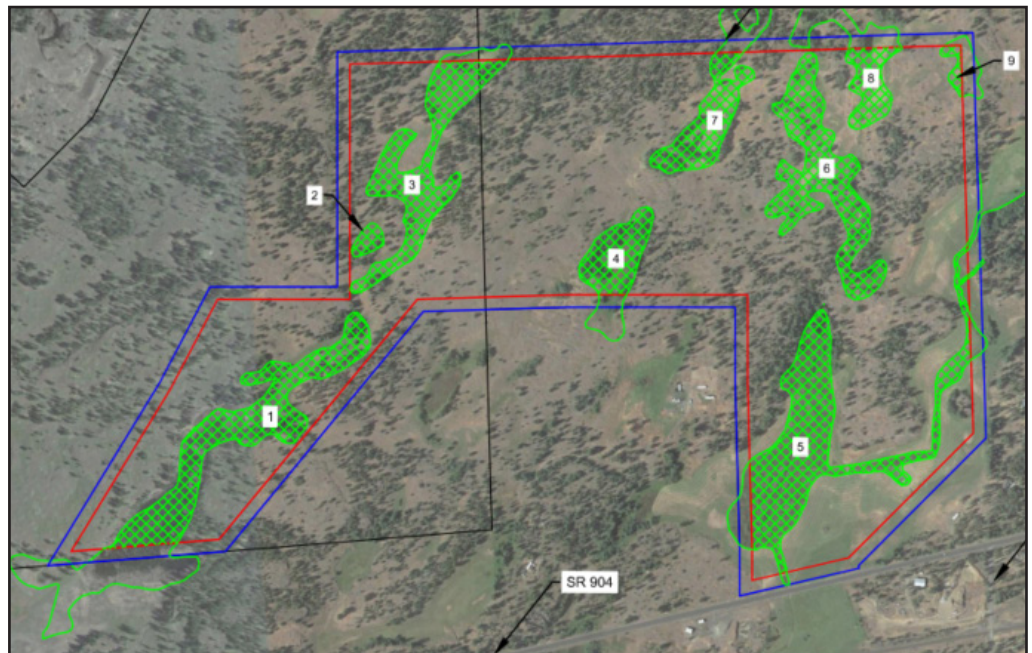

Agencies or entities interested in partnering with S3R3 Solutions in the development of the wetland mitigation bank are encouraged to contact S3R3 Solutions directly.

Karen Corkins, Program Manager, 509-381-3885, karen@s3r3solutions.com